

HydroWhirl® Mini



PVDF Reactionary Force



DESIGN FEATURES

- Fluid-driven, self-flushing
- Compact design, maintenance-free
- Made from FDA-compliant, PVDF material
- Corrosion-resistant
- Hydrostatic wear free slide bearing

SPRAY CHARACTERISTICS

- Vigorous spray action

Spray Angles: Complete 360° spray coverage.

Flow Rates: 10.9 to 33.5 L/min

Max Temperature: 194° F / 90°C

Filtration: Line strainer with a mesh size of 0.3mm/50 mesh

For additional connection types contact BETE.

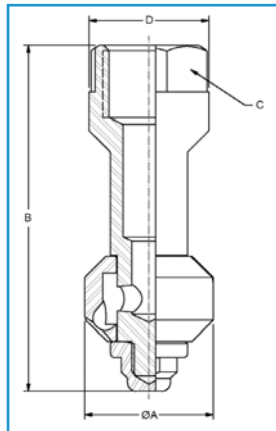

DIMENSIONS IN MILLIMETERS

| Connection Size | A | B | C | Weight (grams) |
|-----------------|------|------|------|----------------|
| 1/2" | 30.5 | 81.3 | 22.9 | 31.1 |

HYDROWHIRL® MINI FLOW RATES

Materials: PVDF

| Female Connection Type | Nozzle Number | Spray Angles | Flow Rate (L/min) @ Differential Pressure (bar) | | | | | | Coverage Dia. @ 3 bar m |
|------------------------|---------------|--------------|---|------|------|------|------|------|----------------------------|
| | | | 0.5 | 0.7 | 1 | 2 | 3 | 4 | |
| | | | bar | bar | bar | bar | bar | bar | |
| 1/2" NPT | HWM 7.2 | 360° | 10.9 | 13.0 | 15.8 | 23.0 | 28.7 | 33.5 | 1.0 |

*Flow rates represent threaded connections with a 360° spray angle.

*Flow rates may vary for other connection types and spray angles.